

This document must not be copied without our written permission, and the contents thereof must not be imparted to a third party nor be used for any unauthorized purpose. Contravention will be prosecuted.

Following standards apply for this drawing:
 SS-EN ISO 8015
 SS-EN ISO 4288 [AD]-TS0062
 see entire drawing for additional standards

ISO 2768mk
 [AD]-TS0061
 (valid if stated on drawing)

Basic size (mm)	Dev. (mm)
-6	+0.1
(6)-30	+0.2
(30)-120	+0.3
(120)-400	+0.5
(400)-1000	+0.8
Ext. radius, chamfer (mm)	Dev. (mm)
-0.5	+0.1
(0.5)-3	+0.2
(3)-6	+0.5
(6)	+1
Angular short length (mm)	Dev. (°)
-1	+3°
(1)-10	+1°
(10)-50	+0°30'
(50)-120	+0°20'
(120)-400	+0°10'
(400)-	+0°5'

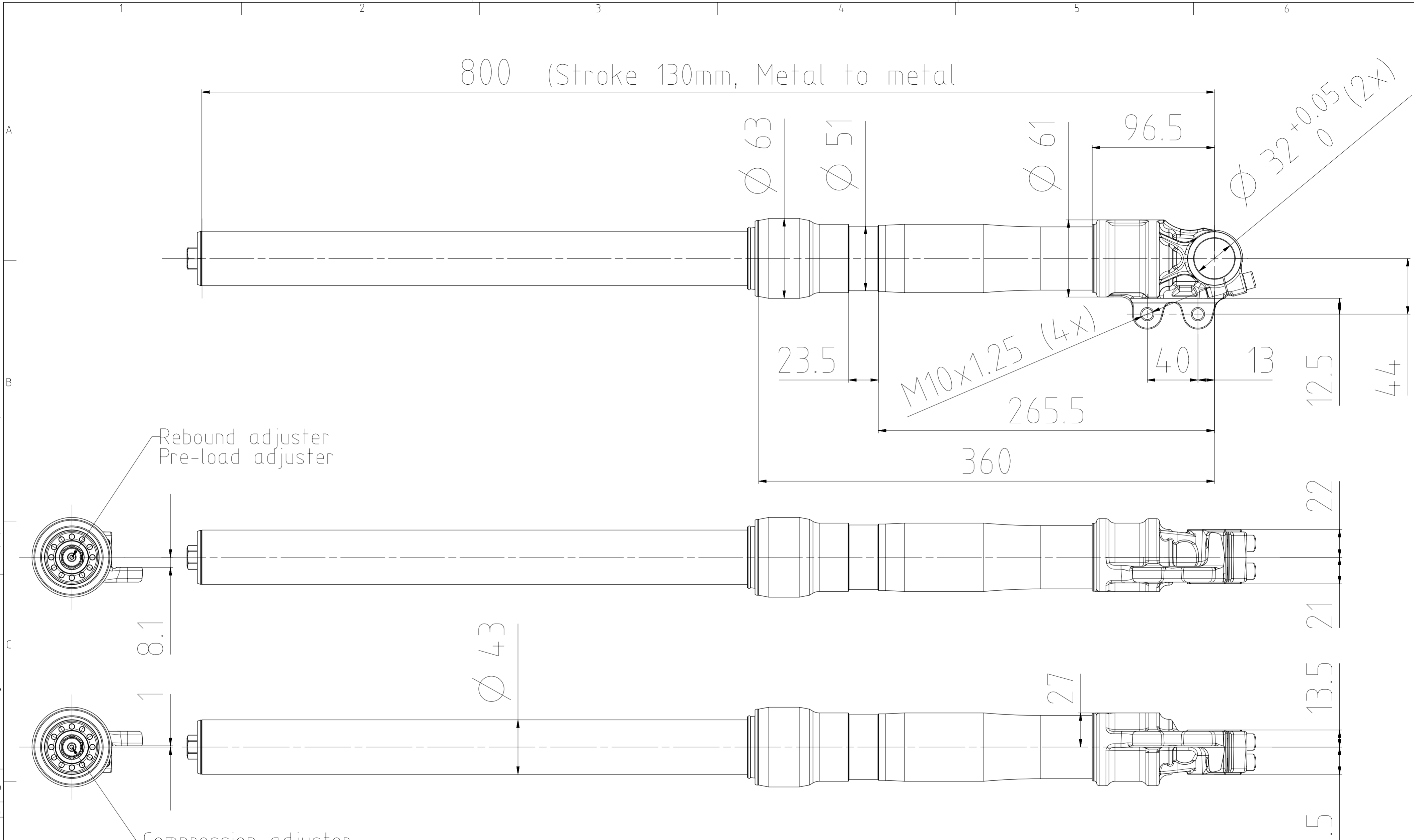
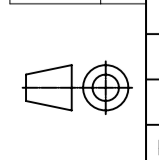

Setup data	
Compression	15 clicks out
Rebound	15 clicks out
Spring pre-load	11 mm
Spring rate	9.5 N/mm
Oil level	210 mm

Rev.	Type of change	Sign.	Date	Rev.no
A	Drawing released for production	HELE	161128	

Material		Heat treatment		Surface treatment	
Date	Drawn	Approved	Format	Scale	Compare
2016-11-28	HELE	TAN	A2	1:2	
Designation (swedish)				Drawing number	
				FG_621	
Designation (english)				Revision	
Retro 43 RWU Black				A	